

Product: X-LINE SLIM RECESSED LED 4400 MICRO-PRM EDD 34 840 LINE-1EP / L-1148MM

Index: 19.4150.5223.34



Description

Luminaire made of aluminium profile. Compared to traditional X-Line G/K LED, the size has been reduced and the structure enclosed in a narrower profile, which allows a more elegant aspect of the product. X-Line Slim Recessed uses an opaline Micro PRM diffuser. All this makes it possible to adjust light and create lighting systems, easing the creation of a comfortable view of indoor spaces and their aesthetics. X-Line Slim Recessed is designed for built-in installation on ceilings. The luminaires are adjusted to be linked together with specially designed connectors, which provide great freedom in arranging elements of the system as well as great functionality.

Product information

Category	Recessed luminaires
Family	X-LINE SLIM RECESSED LED LINE
Name	X-LINE SLIM RECESSED LED 4400 MICRO-PRM EDD 34 840 LINE-1EP / L-1148MM
Index	19.4150.5223.34



Light and electrical data

Light source	LED
Luminous flux LED [lm]	4565
LED power [W]	23,4
Luminaire luminous flux [lm]	3393
Power of luminaire [W]	24,7
Luminaire's light efficiency [lm/W]	137,4
Color of the light [K]	4000
CRI	>80
SDCM (LED sources)	3
Beam angle [°]	(C0-C180) / (C90-C270) - 88,4° / 86°
Protection against electric shock	I
Protection degree	IP40
Voltage	220..240 V, 50..60 Hz
Lifetime of LED sources [h]	100000 (1) / 147000 (2)
Lx/By	L80/B10 (1) / L70/B10 (2)
Operating temperature range [°C]	5 ÷ 30
Driver	DIM DALI (EDD)
Power factor cos φ	>0,9
Circuit load capacity	17 (B10), 28 (B16), 26 (C10), 41 (C16)

Mechanical data

Assembly	mounted in plasterboard ceilings
Material	aluminum
Color	RAL 9016 (white)
Diffuser	Micro-PRM (micro-prismatic diffuser PMMA)
Impact resistant	IK04
Dimensions [mm]	1148 x 70 x 75
Mounting hole [mm]	1143 x 55

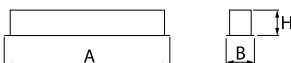

A graph of light

