

Product: ANGLE 3700 40° EDD 21 830

Index: 19.4130.2213.21



Description

Adjustable round downlight designed for ceiling recessed installation. Luminaire body built in die-cast aluminium finished in grey or white. Product built-in an high bright especular reflector without irisation made of high purity aluminium with an angle beam of 20°, 40° or 60°. It is resistant to solids, dust, and liquids penetration – IP20/44. Luminaire sets a ball joint system which allows rotation 355° and tilting 70°. Product is optimised to be used as general and accent lighting for commercial areas shop-windows and different indoor spaces.

Product information

| | |
|----------|---------------------------|
| Category | Recessed luminaires |
| Family | ANGLE |
| Name | ANGLE 3700 40° EDD 21 830 |
| Index | 19.4130.2213.21 |



Light and electrical data

| | |
|-------------------------------------|---|
| Light source | LED |
| Luminous flux LED [lm] | 3995 |
| LED power [W] | 23,3 |
| Luminaire luminous flux [lm] | 3350 |
| Power of luminaire [W] | 26,4 |
| Luminaire's light efficiency [lm/W] | 126,9 |
| Color of the light [K] | 3000 |
| CRI | 82 |
| SDCM (LED sources) | 3 |
| Beam angle [°] | (C0-C180) / (C90-C270) - 33,4° / 33,4° |
| Protection against electric shock | II |
| Protection degree | IP20/44 |
| Voltage | 220..240 V, 50..60 Hz |
| Lifetime of LED sources [h] | 86000 (1) / 100000 (2) / 100000 (3) |
| Lx/By | L90/B10 (1) / L80/B10 (2) / L70/B10 (3) |
| Operating temperature range [°C] | 5 ÷ 30 |
| Driver | DIM DALI (EDD) |
| Power factor cos φ | >0,95 |
| Circuit load capacity | 50 (B10), 80 (B16), 61 (C10), 98 (C16) |

Mechanical data

| | |
|--------------------|------------------------------|
| Assembly | mounted in suspended ceiling |
| Material | aluminum |
| Color | RAL 9006 (grey) |
| Diffuser | hardened transparent glass |
| Impact resistant | IK04 |
| Dimensions [mm] | Ø151 x 125 |
| Mounting hole [mm] | Ø143 |

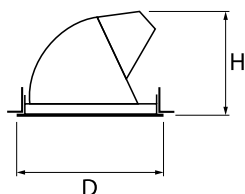

A graph of light

