

Product: MOSAIC LED PART2 1100/1800 PLX EDD 34 840 / BEZ ZASILACZA

Index: 19.4097.7728.34



Description

System dedicated for 600 x 600 module suspended ceilings. It has a module and segment construction that includes the simple element, the curve, +-shaped element, L-shaped element and T-shaped element. Combination of these elements provides unlimited possibilities of interior lighting arrangement. It is possible to combine the lighting functionality and unique aesthetics of the interior. The location of segments can be altered any time by turning particular plaster boards. Owing to the color diffusers or LED RGB strips it is possible to obtain some extra color effects. The LED system can be easily dimmed what provides some extra energy savings.

Product information

Category	Architectural luminaires
Family	MOSAIC LED PART2
Name	MOSAIC LED PART2 1100/1800 PLX EDD 34 840 / BEZ ZASILACZA
Index	19.4097.7728.34



Light and electrical data

Light source	LED
Luminous flux LED [lm]	1152/1800
LED power [W]	7/13
Luminaire luminous flux [lm]	643/1004
Power of luminaire [W]	8/14
Luminaire's light efficiency [lm/W]	80/72
Color of the light [K]	4000
CRI	>80
SDCM (LED sources)	3
Beam angle [°]	(C0-C180) / (C90-C270) - 104,2° / 107,4°
Protection against electric shock	I
Protection degree	IP20/40
Voltage	220..240 V, 50..60 Hz
Lifetime of LED sources [h]	60000
Lx/By	L80/B10
Operating temperature range [°C]	5 ÷ 30
Driver	DIM DALI (EDD) - not included
Power factor cos φ	>0,95

Mechanical data

Assembly	mounted in module ceilings
Material	steel sheet
Color	RAL 9016 (white)
Diffuser	PLX (PMMA opal)
Impact resistant	IK04
Weight [kg]	1,25
Dimensions [mm]	564 x 157 x 61

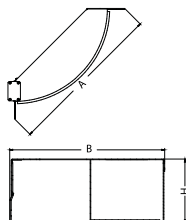

A graph of light

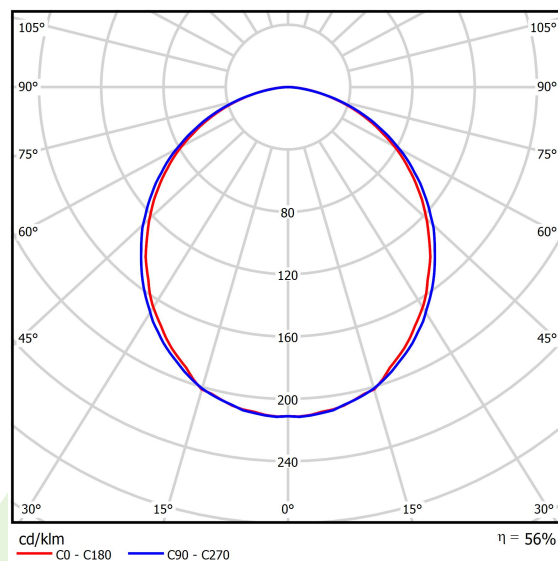

Accessories

Index 19.3025.2000.00

Name MOSAIC LED PART2 - Stencil

