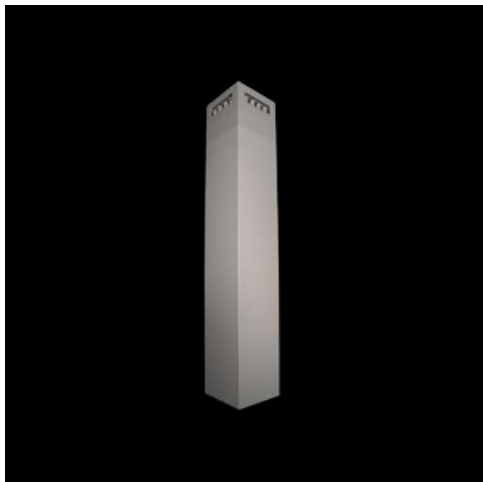

**Product:** KUBIK POLE 900 2/2/2/2 LED 1,7W E IP65 22 6500K**Index:** 19.3160.0078.22

## Description

Outdoor luminaire for assembling on a hardened surface (concrete, sett, or basement) equipped with the highly effective power saving LED sources of the newest generation. It is dedicated to illuminate pedestrian routes such as park alleys, parking spaces communication routes, estate entrances. Luminaire body coated with facade paint dedicated for outdoor usage, light sources placed in upper part of the luminaire with the asymmetric lens providing illumination of the area. IP65 hermetic luminaire, IK09 strike resistant. Luminaire available in variety of colors from RAL color palette upon the clients request. Luminaire height: 300, 600, 900, 3000 and 4000 mm.

## Product information

Category	Outdoor luminaires
Family	KUBIK POLE LED
Name	KUBIK POLE 900 2/2/2/2 LED 1,7W E IP65 22 6500K
Index	19.3160.0078.22



## Light and electrical data

Light source	LED
Luminous flux LED [lm]	1376
LED power [W]	14
Luminaire luminous flux [lm]	1120
Power of luminaire [W]	15
Luminaire's light efficiency [lm/W]	74,7
Color of the light [K]	6500
CRI	>80
SDCM (LED sources)	5
Beam angle [°]	asymmetric light distribution
Protection against electric shock	I
Protection degree	IP65
Voltage	220..240 V, 50..60 Hz
Lifetime of LED sources [h]	50000
Lx/By	L70/B50
Operating temperature range [°C]	-25 ÷ 30
Driver	standard on/off (E)
Power factor cos φ	>0,5
Circuit load capacity	37 (B10), 59 (B16), 61 (C10), 89 (C16)

## Mechanical data

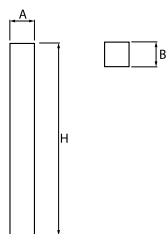

Assembly	for the ground
Material	aluminum
Color	RAL 9007 (dark gray, metallic, fine structure)
Diffuser	transparent polycarbonate
Impact resistant	IK09
Weight [kg]	7,41
Dimensions [mm]	150 x 150 x 900

## A graph of light

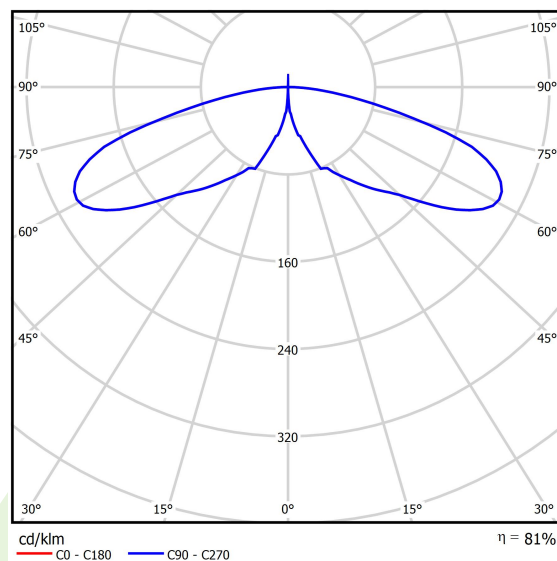

## Accessories

Index 2TJ5782-3

Name 5782-3 Foundations RAL9007

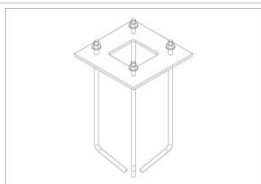

Index 2TJ5782-4

Name 5782-4 Foundations

