



## PLAFOND ROUND LED

---

Surface mounted luminaires

---

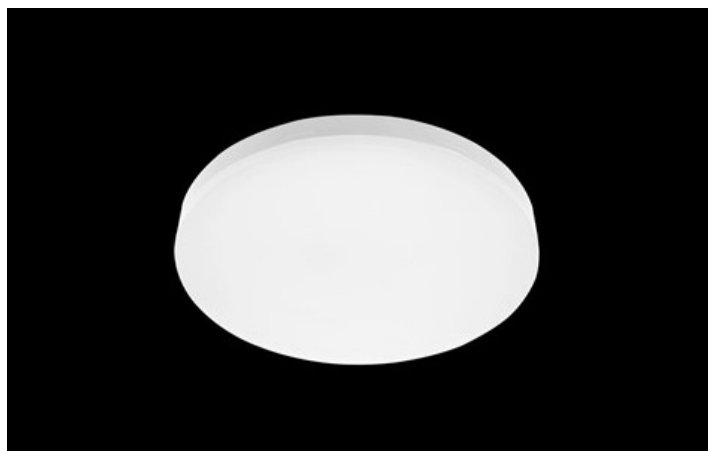

Surface mounted or wall luminary equipped in highly efficient LED panels. Luminary body and diffuser made from IK10 impact resistant material.



## Main parameters:

Name	Luminous flux LED [lm]	Power of luminaire [W]	Color [K]	Dimensions D x H [mm]
PLAFOND ROUND LED 1300	1600	14	4000	Ø280 x 63
PLAFOND ROUND LED 2000	2480	23	4000	Ø280 x 63
PLAFOND ROUND LED 2500	2945	28	4000	Ø280 x 63

## Technical drawing:

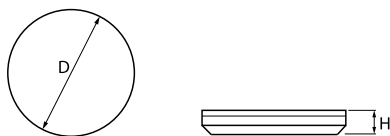

## Light and electrical features:

Light source	LED
Voltage	220..240 V, 50..60 Hz
Lifetime of LED sources [h]	54000
Lx/By	L90
CRI	>80
SDCM (LED sources)	3
Operating temperature range [°C]	0 ÷ 40
Driver	standard on/off (E)

## Mechanical features:

Assembly	surface mounted on ceiling or on wall
Material	polycarbonate
Color	white
Diffuser	PC (opallescent polycarbonate)

## Additional information:

The luminaire can be equipped with a microwave motion sensor.

Note: The power shown refers to the whole system (tolerance +/- 10%).  
The given luminous flux refers to LED light sources (tolerance +/- 10% depends on the value of the colour temperature).  
Technical data may be changed. Photos of the luminaires may differ from reality.  
Date of last update: 24-01-2023