

Product: STREETPARK MINI V2 LED PREMIUM 4600 PARKING E IP66 43 740

Index: 19.4403.2581.43



Description

Streetpark LED Mini/Small provides optimal illumination, ensuring safety for pedestrians and drivers alike. With an efficiency of up to 182 (Mini), 187 (Small) lm/W and a lumen output of up to 7523 lm (Mini) and 17287 lm (Small), it delivers exceptional light quality while maintaining high energy efficiency. Constructed with durable aluminum and electrostatic powder painting for corrosion resistance, Streetpark LED Mini/Small is built to withstand harsh outdoor conditions. Its high-quality LED chips and high-transparent toughened glass with high impact resistance ensure long-lasting performance. The integrated heat radiation design enhances durability, while the smooth roof allows for self-cleaning. The luminaire is available in 4000K color temperature and different beam widths, including park, area, flood, and crossing roads, making it highly versatile for different road and urban applications. It operates in temperatures from -40°C to + 50°C, with an IP66 rating for dust and water resistance, and an IK09 rating for impact protection. The Streetpark LED Mini/Small also features a high-quality LED power supply with driver ON/OFF. With dimensions of 513x180x85 mm (Mini) and 610x205x85 mm (Small), and mounting options for poles or booms, this luminaire is the ideal solution for main roads, expressways, squares, and factories. With a lifespan of 108,000 hours (L95/B10) and a CRI of 70, Streetpark LED Mini/Small ensures high-quality, reliable lighting for any outdoor area.

Product information

Category	Outdoor luminaires
Family	STREETPARK MINI V2 LED PREMIUM
Name	STREETPARK MINI V2 LED PREMIUM 4600 PARKING E IP66 43 740
Index	19.4403.2581.43



Light and electrical data

Light source	LED
Luminous flux LED [lm]	4783,3
LED power [W]	23,6
Luminaire luminous flux [lm]	4046,7
Power of luminaire [W]	25,9
Luminaire's light efficiency [lm/W]	156,2
Color of the light [K]	4000
CRI	>70
SDCM (LED sources)	3
Beam angle [°]	asymmetric light distribution
Photobiological risk class (IEC/EN 62471)	RG0
Protection against electric shock	I
Protection degree	IP66
Voltage	220..240 V, 50..60 Hz
Lifetime of LED sources [h]	108000
Lx/By	L95/B10
Operating temperature range [°C]	-40 ÷ 50
Driver	standard on/off (E)
Circuit load capacity	29 (B10), 46 (B16), 46 (C10), 74 (C16)

Mechanical data

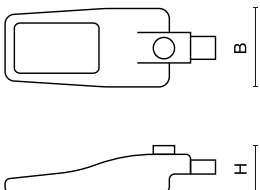

Assembly	mounted on poles
Material	aluminum
Color	RAL 7035 (light gray)
Diffuser	PMMA lenses and hardened transparent glass
Impact resistant	IK09
Dimensions [mm]	513 x 180 x 85

A graph of light

