

Product: STREETPARK MINI V2 LED PREMIUM 9200 ROAD E IP66 43 740

Index: 19.4403.1D81.43



Description

Streetpark LED Mini/Small combines elegance and efficiency, offering optimal lighting for urban streets, roads, and public spaces. With up to 182 (Mini), 187 (Small) lm/W efficiency, and a lumen output of up to 7523 lm (Mini) and 17287 lm (Small), it ensures excellent visibility while reducing energy consumption. Built to withstand harsh outdoor conditions, it's perfect for a wide range of applications, from main roads to squares. The diameter of the mounting bracket is 60 mm.

Product information

| | |
|----------|--|
| Category | Outdoor luminaires |
| Family | STREETPARK MINI V2 LED PREMIUM |
| Name | STREETPARK MINI V2 LED PREMIUM 9200 ROAD E IP66 43 740 |
| Index | 19.4403.1D81.43 |
| EAN | 5902107646769 |



Light and electrical data

| | |
|---|--|
| Light source | LED |
| Luminous flux LED [lm] | 9566 |
| LED power [W] | 47,2 |
| Luminaire luminous flux [lm] | 7059,3 |
| Power of luminaire [W] | 43,9 |
| Luminaire's light efficiency [lm/W] | 160,8 |
| Color of the light [K] | 4000 |
| CRI | >70 |
| SDCM (LED sources) | 3 |
| Beam angle [°] | street light distribution |
| Photobiological risk class (IEC/EN 62471) | RG0 |
| Protection against electric shock | I |
| Protection degree | IP66 |
| Voltage | 220..240 V, 50..60 Hz |
| Lifetime of LED sources [h] | 108000 |
| Lx/By | L95/B10 |
| Operating temperature range [°C] | -40 ÷ 50 |
| Driver | standard on/off (E) |
| Circuit load capacity | 15 (B10), 25 (B16), 25 (C10), 40 (C16) |

Mechanical data

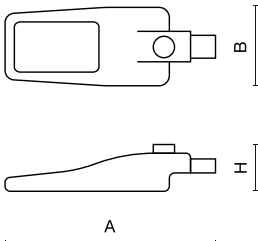

| | |
|------------------|--|
| Assembly | mounted on poles |
| Material | aluminum |
| Color | RAL 7035 (light grey) |
| Diffuser | PMMA lenses and hardened transparent glass |
| Impact resistant | IK09 |
| Dimensions [mm] | 513 x 180 x 85 |

A graph of light

