

Product: STREETPARK SMALL V2 LED PREMIUM 3700 ROAD E IP66 43 740

Index: 19.4402.1281.43



Description

Streetpark LED Mini/Small combines elegance and efficiency, offering optimal lighting for urban streets, roads, and public spaces. With up to 182 (Mini), 187 (Small) lm/W efficiency, and a lumen output of up to 7523 lm (Mini) and 17287 lm (Small), it ensures excellent visibility while reducing energy consumption. Built to withstand harsh outdoor conditions, it's perfect for a wide range of applications, from main roads to squares. The diameter of the mounting bracket is 60 mm.

Product information

Category	Outdoor luminaires
Family	STREETPARK SMALL V2 LED PREMIUM
Name	STREETPARK SMALL V2 LED PREMIUM 3700 ROAD E IP66 43 740
Index	19.4402.1281.43
EAN	5902107645410



Light and electrical data

Light source	LED
Luminous flux LED [lm]	3740,8
LED power [W]	17,4
Luminaire luminous flux [lm]	3284,4
Power of luminaire [W]	19,1
Luminaire's light efficiency [lm/W]	172
Color of the light [K]	4000
CRI	>70
SDCM (LED sources)	3
Beam angle [°]	street light distribution
Photobiological risk class (IEC/EN 62471)	RG0
Protection against electric shock	I
Protection degree	IP66
Voltage	220..240 V, 50..60 Hz
Lifetime of LED sources [h]	108000
Lx/By	L95/B10
Operating temperature range [°C]	-40 ÷ 50
Driver	standard on/off (E)
Circuit load capacity	13 (B10), 21 (B16), 21 (C10), 35 (C16)

Mechanical data

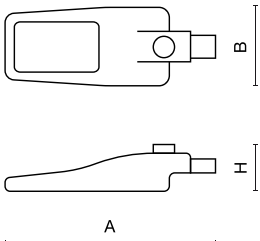

Assembly	mounted on poles
Material	aluminum
Color	RAL 7035 (light grey)
Diffuser	PMMA lenses and hardened transparent glass
Impact resistant	IK09
Dimensions [mm]	610 x 205 x 85

A graph of light

