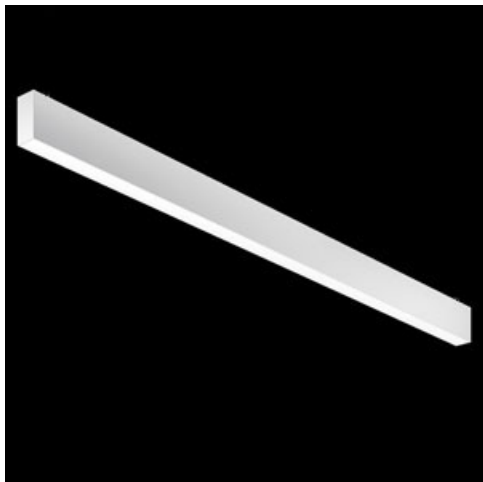

Product: X-LINE SLIGHT SURFACE LED 5200 MICRO-PRM EDD 21 840 LINE-1S / L-2252MM**Index:** 19.4308.4723.21

Description

Linear luminaire with minimized width. Made of 34 mm wide and 68 mm high aluminum profile. Mounting directly on the ceiling. The optical system is fulfilled by an aperture recessed into the body, facing the end cap. Available opal smooth or microprismatic diffuser made of PMMA. Luminaire in system version. Available colours: anodized aluminum, black (RAL 9005), grey (RAL 9006), white (RAL 9016) or any RAL colour on request. End cap aluminum, painted in the colour of the body. Application of luminaires typically for offices, public spaces, community areas in multi-family buildings.

Product information

Category	Surface mounted luminaires
Family	X-LINE SLIGHT SURFACE LED LINE
Name	X-LINE SLIGHT SURFACE LED 5200 MICRO-PRM EDD 21 840 LINE-1S / L-2252MM
Index	19.4308.4723.21



Light and electrical data

Light source	LED
Luminous flux LED [lm]	6036
LED power [W]	27,6
Luminaire luminous flux [lm]	4919,3
Power of luminaire [W]	31,4
Luminaire's light efficiency [lm/W]	156,7
Color of the light [K]	4000
CRI	>80
SDCM (LED sources)	3
Beam angle [°]	(C0-C180) / (C90-C270) - 86,2° / 111°
Photobiological risk class (IEC/EN 62471)	RG0
Protection against electric shock	I
Protection degree	IP40
Voltage	220..240 V, 50..60 Hz
Lifetime of LED sources [h]	80000
Lx/By	L80/B10
Operating temperature range [°C]	5 ÷ 35
Driver	DIM DALI (EDD)
Power factor cos φ	>0,95
Circuit load capacity	17 (B10), 28 (B16), 26 (C10), 41 (C16)

Mechanical data

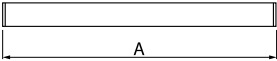

Assembly	directly mounted to ceiling construction
Material	aluminum
Color	RAL 9006 (grey)
Diffuser	Micro-PRM (micro-prismatic diffuser PMMA)
Impact resistant	IK04
Dimensions [mm]	2252 x 34 x 68

A graph of light

