

**Product:** AURORA C/500 4000 PLX EDD 63/04 840

**Index:** 19.4376.4323.63



## Description

Ceiling-mounted circular LED luminaire with integrated, energy-efficient LED module, characterised by uniform light distribution. The body is made of sheet steel, available in white and black. On the outside it is RAL 9003 white, on the inside RAL 9005 black. Three design variants available - A, B and C. Variant A available in two sizes with a diameter of 500 and 350 mm. Diffuser made of opal PMMA. Two colour temperatures of LED sources available - 3000 and 4000 K. Product available with standard on/off power supply or with DALI power supply. The luminaire is designed for indoor use. It is characterised by good surface illumination, so it is particularly dedicated as a source of general light in representative rooms and passageways. The intended use is commercial, HoReCa and residential spaces.

## Product information

|          |                                     |
|----------|-------------------------------------|
| Category | Surface mounted luminaires          |
| Family   | AURORA C                            |
| Name     | AURORA C/500 4000 PLX EDD 63/04 840 |
| Index    | 19.4376.4323.63                     |
| EAN      | 5902107593230                       |



## Light and electrical data

|   |  |
|---|--|
| Light source                              | LED                                      |
| Luminous flux LED [lm]                    | 4218,6                                   |
| LED power [W]                             | 22,3                                     |
| Luminaire luminous flux [lm]              | 2762                                     |
| Power of luminaire [W]                    | 24,9                                     |
| Luminaire's light efficiency [lm/W]       | 110,9                                    |
| Color of the light [K]                    | 4000                                     |
| CRI                                       | >80                                      |
| SDCM (LED sources)                        | 3  |
| Beam angle [°]                            | (C0-C180) / (C90-C270) - 110,2° / 109,6° |
| Photobiological risk class (IEC/EN 62471) | RG0                                      |
| Protection against electric shock         | II                                       |
| Protection degree                         | IP20                                     |
| Voltage                                   | 220..240 V, 50..60 Hz                    |
| Lifetime of LED sources [h]               | 100000                                   |
| Lx/By                                     | L80/B10                                  |
| Operating temperature range [°C]          | 5 ÷ 35                                   |
| Driver                                    | DIM DALI (EDD)                           |
| Power factor cos φ                        | >0,95                                    |
| Circuit load capacity                     | 20 (B10), 30 (B16), 32 (C10), 52 (C16)   |

**Mechanical data**

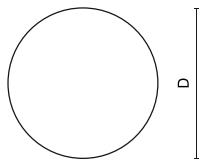

|                  |                                     |
|------------------|-------------------------------------|
| Assembly         | surface mounted on ceiling          |
| Material         | steel sheet                         |
| Color            | RAL 9003 (white) / RAL 9005 (black) |
| Diffuser         | PLX (PMMA opal)                     |
| Impact resistant | IK04                                |
| Dimensions [mm]  | Ø500 x 125                          |

**A graph of light**

