

Product: AURORA C/500 3000 PLX EDD 63/04 840

Index: 19.4376.4123.63



Description

Ceiling-mounted circular LED luminaire with integrated, energy-efficient LED module, characterised by uniform light distribution. The body is made of sheet steel, available in white and black. On the outside it is RAL 9003 white, on the inside RAL 9005 black. Three design variants available - A, B and C. Variant A available in two sizes with a diameter of 500 and 350 mm. Diffuser made of opal PMMA. Two colour temperatures of LED sources available - 3000 and 4000 K. Product available with standard on/off power supply or with DALI power supply. The luminaire is designed for indoor use. It is characterised by good surface illumination, so it is particularly dedicated as a source of general light in representative rooms and passageways. The intended use is commercial, HoReCa and residential spaces.

Product information

Category	Surface mounted luminaires
Family	AURORA C
Name	AURORA C/500 3000 PLX EDD 63/04 840
Index	19.4376.4123.63
EAN	5902107593155



Light and electrical data

Light source	LED
Luminous flux LED [lm]	3078
LED power [W]	15,6
Luminaire luminous flux [lm]	2015
Power of luminaire [W]	17,5
Luminaire's light efficiency [lm/W]	115,1
Color of the light [K]	4000
CRI	>80
SDCM (LED sources)	3
Beam angle [°]	(C0-C180) / (C90-C270) - 110,2° / 109,6°
Photobiological risk class (IEC/EN 62471)	RG0
Protection against electric shock	II
Protection degree	IP20
Voltage	220..240 V, 50..60 Hz
Lifetime of LED sources [h]	100000
Lx/By	L80/B10
Operating temperature range [°C]	5 ÷ 35
Driver	DIM DALI (EDD)
Power factor cos φ	>0,95
Circuit load capacity	20 (B10), 30 (B16), 32 (C10), 52 (C16)

Mechanical data

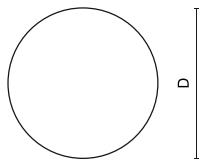

Assembly	surface mounted on ceiling
Material	steel sheet
Color	RAL 9003 (white) / RAL 9005 (black)
Diffuser	PLX (PMMA opal)
Impact resistant	IK04
Dimensions [mm]	Ø500 x 125

A graph of light

