

Product: RUBIN ROUND 300 LED 1400 PLX EDD 21 830 / H-90MM

Index: 19.4357.9113.21



Description

The fitting is used in public buildings such as banks, offices, hotels, stores, schools, that is wherever pleasant environment is of special importance. Rubin O gives the interior style and individuality. The special construction of this fitting and its diffusers permit to restrict glare. The housing is made of steel plate, powder painted, diffusers applied are opal.

Product information

Category	Surface mounted luminaires
Family	RUBIN ROUND LED
Name	RUBIN ROUND 300 LED 1400 PLX EDD 21 830 / H-90MM
Index	19.4357.9113.21
EAN	5902107321475



Light and electrical data

Light source	LED
Luminous flux LED [lm]	1381
LED power [W]	9
Luminaire luminous flux [lm]	1136
Power of luminaire [W]	10
Luminaire's light efficiency [lm/W]	113,6
Color of the light [K]	3000
CRI	>80
SDCM (LED sources)	3
Beam angle [°]	(C0-C180) / (C90-C270) - 107,4° / 107,6°
Photobiological risk class (IEC/EN 62471)	RG0
Protection against electric shock	I
Protection degree	IP20
Voltage	220..240 V, 50..60 Hz
Lifetime of LED sources [h]	60000
Lx/By	L80/B10
Operating temperature range [°C]	5 ÷ 30
Driver	DIM DALI (EDD)
Power factor cos φ	>0,95
Circuit load capacity	20 (B10), 31 (B16), 33 (C10), 53 (C16)

Mechanical data



Assembly	directly mounted to ceiling construction or surface mounted on slings using accessories
Material	steel sheet
Color	RAL 9006 (grey, metallic, fine structure)
Diffuser	PLX (PMMA opal)
Impact resistant	IK04
Weight [kg]	2,31
Dimensions [mm]	Ø300 x 98

A graph of light

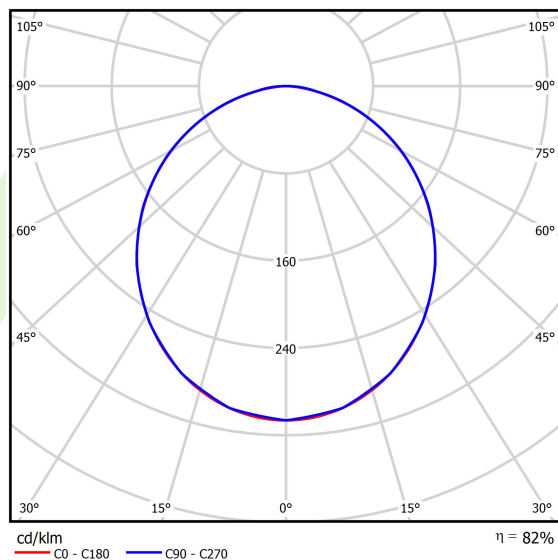

Accessories

Index	6E1-1600-3-STR5
Name	SUSPENSION NEW TYPE-O 21 LENGHT 1,6M WIRE 5X 3- POINTS



Index	6E1-500OKW1P-5
Name	SUSPENSION NEW TYPE-J 34 LENGHT 1,5M WIRE 5X 1-POINT



Index	19.3272.1205.00
Name	SUSPENSION NEW TYPE-E LENGHT-1,5 METER WITHOUT WIRE 1-POINT

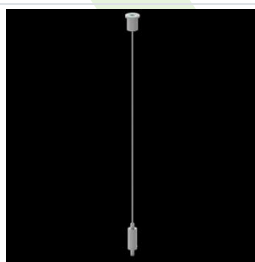

Luminous flux tolerance +/- 10%. Power tolerance +/- 10%.
 Technical data may be changed. Photos of the luminaires may differ from reality.
 Date of last update: 16-12-2025