

**Product:** AGALINE LED 4000 E 34 830 / L-565MM

**Index:** 19.4209.1111.34



## Description

Agaline is an industrial modular system for installing in straight lines. Agaline is an excellent option for lighting industrial premises and warehouses, but is also suitable for offices, supermarkets and commercial spaces. A luminaire mounted in line systems, made of sheet steel, painted in white. Individual elements of the system combined with connectors. Through-cabling ensures easy and fast installation. To be applied in industrial objects and other places, where high intensity and uniformity of lighting is necessary. ATTENTION: Lenght 2805mm for special request.

## Product information

|          |                                     |
|----------|-------------------------------------|
| Category | Industrial luminaires               |
| Family   | AGALINE LED                         |
| Name     | AGALINE LED 4000 E 34 830 / L-565MM |
| Index    | 19.4209.1111.34                     |
| EAN      | 5902107428372                       |



## Light and electrical data

|   |  |
|---|--|
| Light source                              | LED                                      |
| Luminous flux LED [lm]                    | 4131,7                                   |
| LED power [W]                             | 20,6                                     |
| Luminaire luminous flux [lm]              | 4131,7                                   |
| Power of luminaire [W]                    | 23,1                                     |
| Luminaire's light efficiency [lm/W]       | 178,9                                    |
| Color of the light [K]                    | 3000                                     |
| CRI                                       | >80                                      |
| SDCM (LED sources)                        | 3  |
| Beam angle [°]                            | (C0-C180) / (C90-C270) - 114,4° / 114,4° |
| Photobiological risk class (IEC/EN 62471) | RG0                                      |
| Protection against electric shock         | I  |
| Protection degree                         | IP20                                     |
| Voltage                                   | 220..240 V, 50..60 Hz                    |
| Lifetime of LED sources [h]               | 100000                                   |
| Lx/By                                     | L80/B10                                  |
| Operating temperature range [°C]          | 5 ÷ 35                                   |
| Driver                                    | standard on/off (E)                      |

## Mechanical data

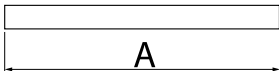

|                  |                           |
|------------------|---------------------------|
| Assembly         | surface mounted on slings |
| Material         | steel sheet               |
| Color            | RAL 9016 (white)          |
| Diffuser         | none                      |
| Impact resistant | IK04                      |
| Dimensions [mm]  | 565 x 56 x 45             |



Accessories

|       |                       |
|-------|-----------------------|
| Index | 0E1ALLS-SP            |
| Name  | AGALINE LED CONNECTOR |



|       |                        |
|-------|------------------------|
| Index | 0E1ALLS-E              |
| Name  | AGALINE LED END-CAP 34 |



|       |  |
|-------|--|
| Index | 0E1ALLS-EP                               |
| Name  | AGALINE LED END-CAP 34<br>Through wiring |

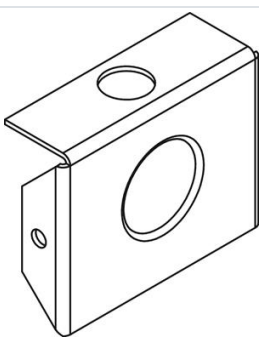

|       |                        |
|-------|------------------------|
| Index | 1E1AL8030-1-3          |
| Name  | COVER 8030-1-3 RAL9016 |

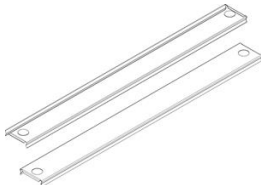

|       |   |
|-------|---|
| Index | 6E1-500KW34K-3  |
| Name  | SUSPENSION NEW TYPE-A+B 34<br>LENGHT 1,5M WIRE 3X SET |



|       |   |
|-------|---|
| Index | 6E1-8670-B-1,5-3X   |
| Name  | SUSPENSION NEW TYPE-F<br>LENGHT-1,5 METER WIRE 3X 1-<br>POINT |



|       |   |
|-------|---|
| Index | 19.3272.1205.00   |
| Name  | SUSPENSION NEW TYPE-E<br>LENGHT-1,5 METER WITHOUT<br>WIRE 1-POINT |

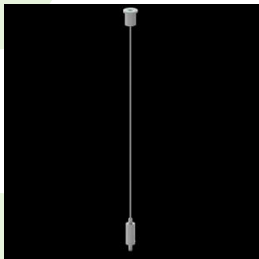

|       |   |
|-------|---|
| Index | 6E1-500KWB34K-3                                       |
| Name  | SUSPENSION NEW TYPE-A+E 34<br>LENGHT 1,5M WIRE 3X SET |

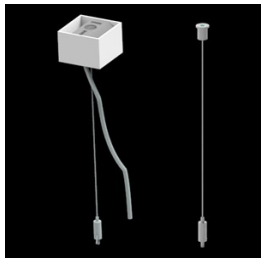

|       |   |
|-------|---|
| Index | 6E1-9875-4-1,5-3X   |
| Name  | SUSPENSION NEW TYPE-D<br>LENGHT-1,5 METER WIRE 3X 1-<br>POINT |



|       |   |
|-------|---|
| Index | 6E1-9875-3-1,5  |
| Name  | SUSPENSION NEW TYPE-C<br>LENGHT-1,5 METER WITHOUT<br>WIRE 1-POINT |

