

Product: PATOS-LINE LED 2600 MICRO-PRM EDD 830 LINE-1S / CONNECTOR TYPE-LB 600/600

Index: 19.4247.4613.34



Description

Nowadays architectural lighting should embody an irreproachable style and high quality of lighting parameters. A luminaire is expected to be exceptional in respect of its design – simple and elegant. Patos is designed for lighting galleries, museums, offices, clubs, restaurants and hotels; it gives any interior individual modern character. Fitting designed for suspended plasterboard ceilings, adapted to befit the ceiling surface. Body made of aluminium profile, prismatic diffuser with very good light transmission coefficient and light diffusion parameters. Mounting should take place before the ceiling surface is finished. After the finishing work of the ceiling is ended, the diffuser is installed.

Product information

| | |
|----------|---|
| Category | Architectural luminaires |
| Family | PATOS LINE LED CONNECTOR L |
| Name | PATOS-LINE LED 2600 MICRO-PRM EDD 830 LINE-1S / CONNECTOR TYPE-LB 600/600 |
| Index | 19.4247.4613.34 |



Light and electrical data

| | |
|-------------------------------------|--|
| Light source | LED |
| Luminous flux LED [lm] | 2525 |
| LED power [W] | 13,3 |
| Luminaire luminous flux [lm] | 1902 |
| Power of luminaire [W] | 14,4 |
| Luminaire's light efficiency [lm/W] | 132,1 |
| Color of the light [K] | 3000 |
| CRI | >80 |
| SDCM (LED sources) | 3 |
| Beam angle [°] | (C0-C180) / (C90-C270) - 82,8° / 97,2° |
| Protection against electric shock | I |
| Protection degree | IP20 |
| Voltage | 220..240 V, 50..60 Hz |
| Lifetime of LED sources [h] | 100000 (1) / 147000 (2) |
| Lx/By | L80/B10 (1) / L70/B50 (2) |
| Operating temperature range [°C] | 5 ÷ 30 |
| Driver | DIM DALI (EDD) |
| Power factor cos φ | >0,95 |
| Circuit load capacity | 14 (B10), 24 (B16), 22 (C10), 36 (C16) |

Mechanical data

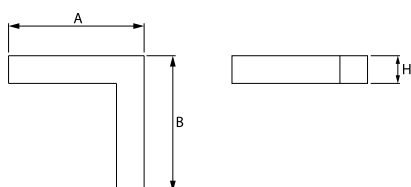

| | |
|--------------------|---|
| Assembly | mounted in plasterboard ceilings |
| Material | steel sheet |
| Color | white |
| Diffuser | Micro-PRM (micro-prismatic diffuser PMMA) |
| Impact resistant | IK04 |
| Dimensions [mm] | 602 x 602 x 83 |
| Mounting hole [mm] | 604 x 604 x 80 |

A graph of light

