

**Product:** BERYL KN LED UP&DOWN 2x2,4W 5°-21° E IP40 21 865

**Index:** 19.4241.52B1.21



## Description

Luminaire adapted to be mounted on walls. High lighting efficiency LEDs were used as light sources. Optical system consists of professional lens that provide light distribution of 5-21° angle. Owing to the optical system solutions, the product is highly effective. Its body is made from anodized aluminum profile. It is resistant to solids, dust, and liquids penetration – IP40 or IP65. This type of luminaire is recommended for decorative or accent illumination, e.g. in restaurants, pubs, or cafes.

## Product information

Category	Architectural luminaires
Family	BERYL KN LED UP&DOWN
Name	BERYL KN LED UP&DOWN 2x2,4W 5°-21° E IP40 21 865
Index	19.4241.52B1.21
EAN	5902107035426



## Light and electrical data

Light source	LED
Luminous flux LED [lm]	426
LED power [W]	5
Luminaire luminous flux [lm]	343
Power of luminaire [W]	7
Luminaire's light efficiency [lm/W]	49
Color of the light [K]	6500
CRI	>80
Beam angle [°]	(C0-C180) / (C90-C270) - 36° / 9,6°
Protection against electric shock	I
Protection degree	IP40
Voltage	220..240 V, 50..60 Hz
Lifetime of LED sources [h]	50000
Lx/By	L70/B50
Operating temperature range [°C]	5 ÷ 30
Driver	standard on/off (E)
Circuit load capacity	80 (B10), 157 (B16), 265 (C10), 317 (C16)

**Mechanical data**

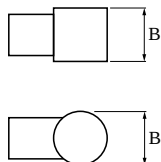

Assembly	<b>mounted on wall</b>
Material	<b>aluminum</b>
Color	<b>RAL 9006 (grey, metallic, fine structure)</b>
Diffuser	<b>transparent polycarbonate</b>
Impact resistant	<b>IK04</b>
Dimensions [mm]	<b>75 x 50 x 148</b>

**A graph of light**

