

**Product:** ANGLE 3700 60° E 21 840

**Index:** 19.4130.2321.21



## Description

Adjustable round downlight designed for ceiling recessed installation. Luminaire body built in die-cast aluminium finished in grey or white. Product built-in an high bright especular reflector without irisation made of high purity aluminium with an angle beam of 20°, 40° or 60°. It is resistant to solids, dust, and liquids penetration – IP20/44. Luminaire sets a ball joint system which allows rotation 355° and tilting 70°. Product is optimised to be used as general and accent lighting for commercial areas shop-windows and different indoor spaces.

## Product information

|          |                         |
|----------|-------------------------|
| Category | Recessed luminaires     |
| Family   | ANGLE                   |
| Name     | ANGLE 3700 60° E 21 840 |
| Index    | 19.4130.2321.21         |



## Light and electrical data

|                                     |   |
|-------------------------------------|---|
| Light source                        | LED                                     |
| Luminous flux LED [lm]              | 4111                                    |
| LED power [W]                       | 23,3                                    |
| Luminaire luminous flux [lm]        | 3266                                    |
| Power of luminaire [W]              | 26,4                                    |
| Luminaire's light efficiency [lm/W] | 123,7                                   |
| Color of the light [K]              | 4000                                    |
| CRI                                 | 82                                      |
| SDCM (LED sources)                  | 3                                       |
| Beam angle [°]                      | (C0-C180) / (C90-C270) - 53,2° / 53,2°  |
| Protection against electric shock   | II                                      |
| Protection degree                   | IP20/44                                 |
| Voltage                             | 220..240 V, 50..60 Hz                   |
| Lifetime of LED sources [h]         | 86000 (1) / 100000 (2) / 100000 (3)     |
| Lx/By                               | L90/B10 (1) / L80/B10 (2) / L70/B10 (3) |
| Operating temperature range [°C]    | 5 ÷ 30                                  |
| Driver                              | standard on/off (E)                     |
| Power factor cos φ                  | >0,95                                   |
| Circuit load capacity               | 39 (B10), 62 (B16), 65 (C10), 104 (C16) |

## Mechanical data

|                    |                              |
|--------------------|------------------------------|
| Assembly           | mounted in suspended ceiling |
| Material           | aluminum                     |
| Color              | RAL 9006 (grey)              |
| Diffuser           | hardened transparent glass   |
| Impact resistant   | IK04                         |
| Dimensions [mm]    | Ø151 x 125                   |
| Mounting hole [mm] | Ø143                         |

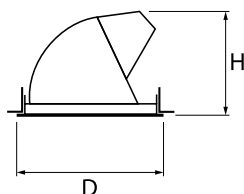

## A graph of light

