

Product: UNIVERSAL LINE LED 4400 PLX E 24 IP20 840 LINE-S / L-1159MM

Index: 19.4196.1921.24



Description

Universal Line system is built on the base of aluminium profile of crosswise dimension after assembly 60 mm x 75 mm, LED strips and linear lenses. Standard colour - natural anodized aluminium. Installation: - surface mounted line (spring plates to the ceiling) - suspended line. The construction of the luminaire ensures one of the three levels of protection: IP20, IP55 or IP65. IP20 and IP65 versions of the product are dedicated for internal use. Versions IP55 of the luminaire are dedicated for external use. In order to achieve the level of protection IP55, luminaires should be installed purely and simply on a horizontal surface, illuminating part should be directed downwards. It is forbidden to install the luminaire on the wall or directed upwards.

Product information

| | |
|----------|---|
| Category | Surface mounted luminaires |
| Family | UNIVERSAL LINE LED |
| Name | UNIVERSAL LINE LED 4400 PLX E 24 IP20 840 LINE-S / L-1159MM |
| Index | 19.4196.1921.24 |



Light and electrical data

| | |
|-------------------------------------|--|
| Light source | LED |
| Luminous flux LED [lm] | 4565 |
| LED power [W] | 23,4 |
| Luminaire luminous flux [lm] | 3434 |
| Power of luminaire [W] | 24,7 |
| Luminaire's light efficiency [lm/W] | 139 |
| Color of the light [K] | 4000 |
| CRI | >80 |
| SDCM (LED sources) | 3 |
| Beam angle [°] | (C0-C180) / (C90-C270) - 109,6° / 109,6° |
| Protection against electric shock | I |
| Protection degree | IP20 |
| Voltage | 220..240 V, 50..60 Hz |
| Lifetime of LED sources [h] | 100000 (1) / 147000 (2) |
| Lx/By | L80/B10 (1) / L70/B50 (2) |
| Operating temperature range [°C] | -25 ÷ 30 |
| Driver | standard on/off (E) |
| Power factor cos φ | >0,95 |
| Circuit load capacity | 30 (B10), 48 (B16), 43 (C10), 70 (C16) |

Mechanical data



| | |
|------------------|---|
| Assembly | directly mounted to ceiling construction or surface mounted on slings |
| Material | aluminum |
| Color | anodised aluminum |
| Diffuser | PLX (PMMA opal) |
| Impact resistant | IK04 |
| Dimensions [mm] | 1159 x 60 x 75 |

A graph of light

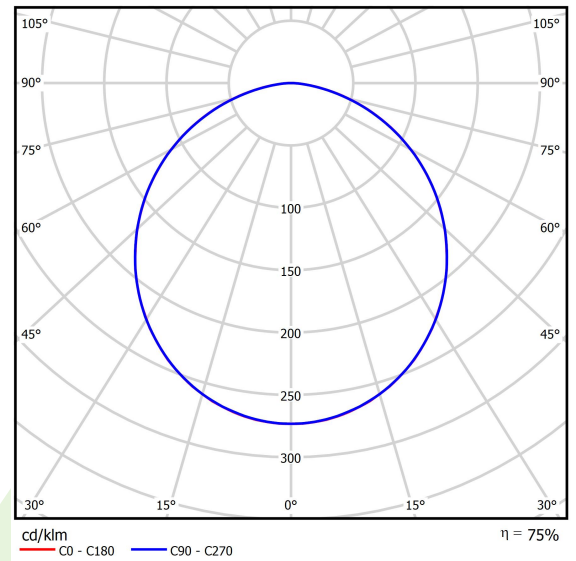

Accessories

Index 01LU-UN

Name Universal Line - ceiling clip



Index 01LU-UPZ

Name Universal Line - clips fot slings



Index 6E1-500KWANK-5

Name SUSPENSION NEW TYPE-A+B 24
LENGHT 1,5M WIRE 5X SET

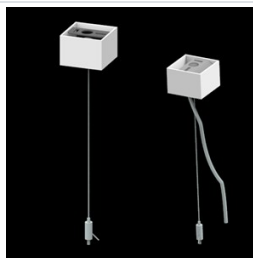

Index 6E1-8670-B-1,5-5X

Name SUSPENSION NEW TYPE-F
LENGHT-1,5 METER WIRE 5X 1-
POINT



Index 19.3272.1205.00

Name SUSPENSION NEW TYPE-E
LENGHT-1,5 METER WITHOUT
WIRE 1-POINT

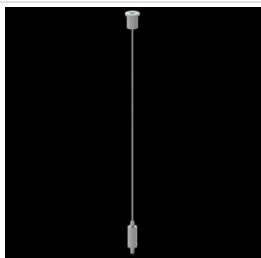

Index 6E1-500KWB24K-5

Name SUSPENSION NEW TYPE-A+E 24
LENGHT 1,5M WIRE 5X SET

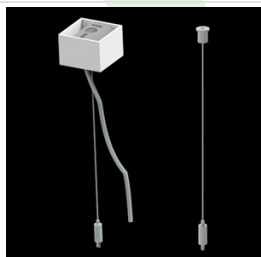

Index 6E1-500KWAN1P-5

Name SUSPENSION NEW TYPE-A 24
LENGHT 1,5M WIRE 5X 1-POINT

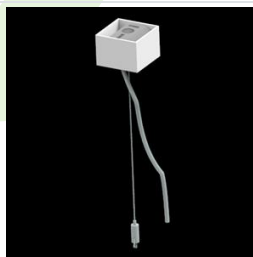

Index 6E1-500KWAN1P-B

Name SUSPENSION NEW TYPE-B 24
LENGHT 1,5M WITHOUT WIRE 1-
POINT

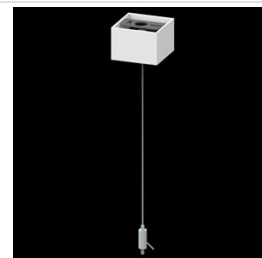

Index 6E1-9875-4-1,5-5X

Name SUSPENSION NEW TYPE-D
LENGHT-1,5 METER WIRE 5X 1-
POINT

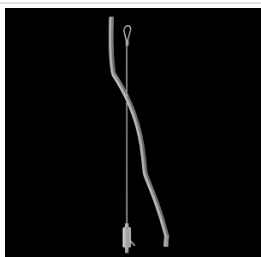

Index 6E1-9875-3-1,5

Name SUSPENSION NEW TYPE-C
LENGHT-1,5 METER WITHOUT
WIRE 1-POINT

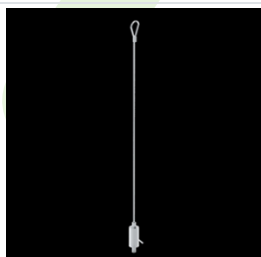

Index 01LU-ŁKPL

Name UNIVERSAL LINE CONNECTOR
KPL.

