

**Product:** X-LINE G/K LED 1950 MICRO-PRM E 24 830 LINE-S / CONNECTOR TYPE-LC 600/300

**Index:** 19.4173.2111.24



## Description

The group of X-line luminaires is made of aluminum profile with opal diffuser or micro-prismatic diffuser. The luminaires may be joined with special connectors providing great freedom in arranging elements of the system and its functionality.

## Product information

Category	<b>Recessed luminaires</b>
Family	<b>X-LINE G/K LED CONNECTOR L</b>
Name	<b>X-LINE G/K LED 1950 MICRO-PRM E 24 830 LINE-S / CONNECTOR TYPE-LC 600/300</b>
Index	<b>19.4173.2111.24</b>



## Light and electrical data

Light source	<b>LED</b>
Luminous flux LED [lm]	<b>1895</b>
LED power [W]	<b>10,3</b>
Luminaire luminous flux [lm]	<b>1427</b>
Power of luminaire [W]	<b>11,1</b>
Luminaire's light efficiency [lm/W]	<b>128,6</b>
Color of the light [K]	<b>3000</b>
CRI	<b>&gt;80</b>
SDCM (LED sources)	<b>3</b>
Beam angle [°]	<b>(C0-C180) / (C90-C270) - 82,8° / 97,2°</b>
Protection against electric shock	<b>I</b>
Protection degree	<b>IP20/44</b>
Voltage	<b>220..240 V, 50..60 Hz</b>
Lifetime of LED sources [h]	<b>100000 (1) / 147000 (2)</b>
Lx/By	<b>L80/B10 (1) / L70/B50 (2)</b>
Operating temperature range [°C]	<b>5 ÷ 30</b>
Driver	<b>standard on/off (E)</b>
Power factor cos φ	<b>&gt;0,95</b>
Circuit load capacity	<b>46 (B10), 74 (B16), 72 (C10), 115 (C16)</b>

## Mechanical data

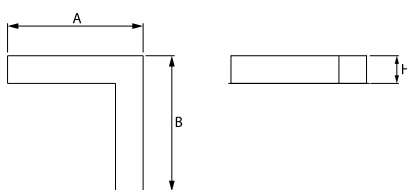

Assembly	<b>mounted in plasterboard ceilings</b>
Material	<b>aluminum</b>
Color	<b>anodised aluminum</b>
Diffuser	<b>Micro-PRM (micro-prismatic diffuser PMMA)</b>
Impact resistant	<b>IK04</b>
Dimensions [mm]	<b>603 x 323 x 134</b>
Mounting hole [mm]	<b>598 x 318 x 70</b>

## A graph of light

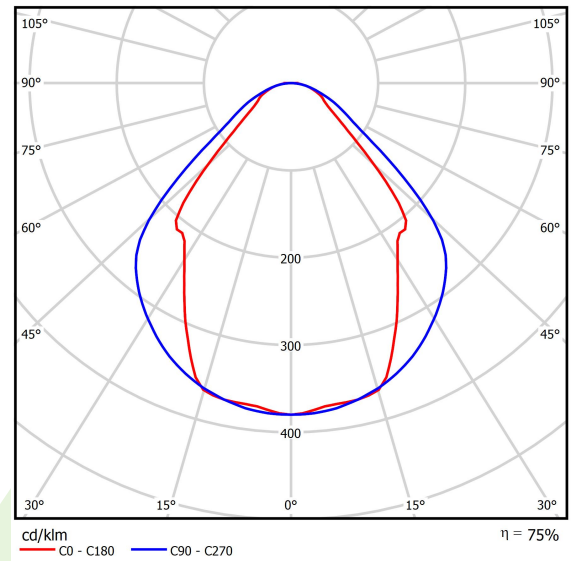

## Accessories

Index 0E1XLL-SLED

Name X-LINE Clamp for line luminaires

