

Product: X-LINE G/K LED 3300 MICRO-PRM EDD 24 830 LINE-1S / CONNECTOR TYPE-LE 600/300

Index: 19.4173.6313.24



Description

The group of X-line luminaires is made of aluminum profile with opal diffuser or micro-prismatic diffuser. The luminaires may be joined with special connectors providing great freedom in arranging elements of the system and its functionality.

Product information

Category	Recessed luminaires
Family	X-LINE G/K LED CONNECTOR L
Name	X-LINE G/K LED 3300 MICRO-PRM EDD 24 830 LINE-1S / CONNECTOR TYPE-LE 600/300
Index	19.4173.6313.24



Light and electrical data

Light source	LED
Luminous flux LED [lm]	3316
LED power [W]	17,4
Luminaire luminous flux [lm]	2498
Power of luminaire [W]	19,2
Luminaire's light efficiency [lm/W]	130,1
Color of the light [K]	3000
CRI	>80
SDCM (LED sources)	3
Beam angle [°]	(C0-C180) / (C90-C270) - 82,8° / 97,2°
Protection against electric shock	I
Protection degree	IP20/44
Voltage	220..240 V, 50..60 Hz
Lifetime of LED sources [h]	100000 (1) / 147000 (2)
Lx/By	L80/B10 (1) / L70/B50 (2)
Operating temperature range [°C]	5 ÷ 30
Driver	DIM DALI (EDD)
Power factor cos φ	>0,95
Circuit load capacity	17 (B10), 28 (B16), 26 (C10), 41 (C16)

Mechanical data

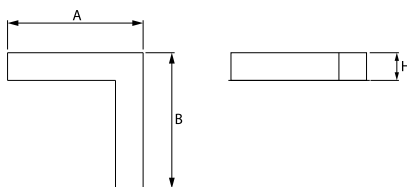

Assembly	mounted in plasterboard ceilings
Material	aluminum
Color	anodised aluminum
Diffuser	Micro-PRM (micro-prismatic diffuser PMMA)
Impact resistant	IK04
Dimensions [mm]	603 x 323 x 134
Mounting hole [mm]	598 x 318 x 70

A graph of light



Accessories

Index 0E1XLL-SLED

Name X-LINE Clamp for line luminaires

