

Product: BERYL KN LED 1X1,2W 5°-21° E 21 830

Index: 19.3012.0001.21



Description

Decorative luminary of 1,5 W, and IP40 dust and water protection class. It is made from powder coated aluminum (RAL9006 standard). The standard light distribution is achieved owing to $\pm 5^\circ \times \pm 21^\circ$ lens. It is also possible to use the symmetric light distribution of 45° . Luminary designed for accent and decorative illumination in such areas as restaurants, pubs, or cafés.

Product information

Category	Architectural luminaires
Family	BERYL KN LED
Name	BERYL KN LED 1X1,2W 5°-21° E 21 830
Index	19.3012.0001.21



Light and electrical data

Light source	LED
Luminous flux LED [lm]	87
LED power [W]	1
Luminaire luminous flux [lm]	80
Power of luminaire [W]	2
Luminaire's light efficiency [lm/W]	40
Color of the light [K]	3000
CRI	>80
SDCM (LED sources)	5
Beam angle [°]	(C0-C180) / (C90-C270) - 36° / 9,6°
Protection against electric shock	I
Protection degree	IP40
Voltage	220..240 V, 50..60 Hz
Lifetime of LED sources [h]	60000
Lx/By	L70/B50
Operating temperature range [°C]	5 ÷ 30
Driver	standard on/off (E)
Circuit load capacity	80 (B10), 157 (B16), 265 (C10), 317 (C16)

Mechanical data

Assembly	surface mounted on ceiling
Material	aluminum
Color	RAL 9006 (gray, metallic, fine structure)
Diffuser	transparent polycarbonate
Impact resistant	IK04
Dimensions [mm]	45 x 45 x 120

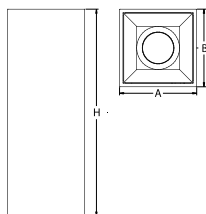

A graph of light

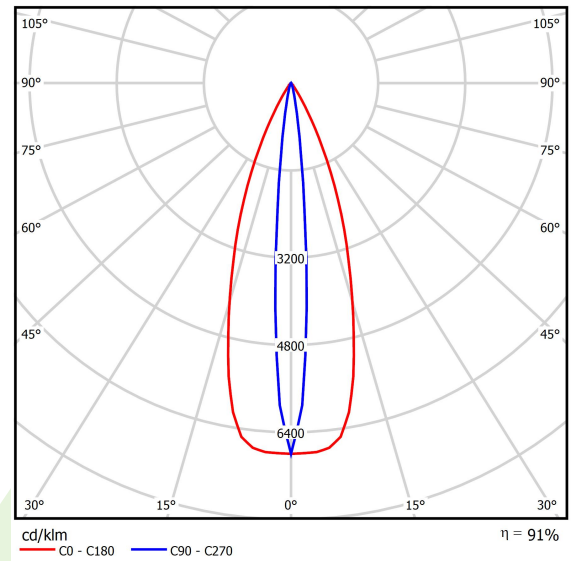

Luminous flux tolerance +/- 10%. Power tolerance +/- 10%.
Technical data may be changed. Photos of the luminaires may differ from reality.
Date of last update: 10-08-2022