



## BERYL SURFACE LED COMPACT

---

Compact

---



Small downlight ceiling luminaire. Several variants of the diffusers and different light distributions available. Simple assembly. Perfect for lighting corridors, reception, cloakrooms.



## Main parameters:

Name	Luminous flux LED [lm]	Power of luminaire [W]	Color [K]	Dimensions D x H [mm]
BERYL SURFACE LED COMPACT 1000 13°	1328	9,8	4000	Ø108 x 175
BERYL SURFACE LED COMPACT 1000 24°	1328	9,8	4000	Ø108 x 175
BERYL SURFACE LED COMPACT 1000 36°	1328	9,8	4000	Ø108 x 175
BERYL SURFACE LED COMPACT 1000 60°	1328	9,8	4000	Ø108 x 175
BERYL SURFACE LED COMPACT 1000	1328	9,8	4000	Ø108 x 175
BERYL SURFACE LED COMPACT 1800 13°	2058	12,8	4000	Ø108 x 175
BERYL SURFACE LED COMPACT 1800 24°	2058	12,8	4000	Ø108 x 175
BERYL SURFACE LED COMPACT 1800 36°	2058	12,8	4000	Ø108 x 175
BERYL SURFACE LED COMPACT 1800 60°	2058	12,8	4000	Ø108 x 175
BERYL SURFACE LED COMPACT 1800	2058	12,8	4000	Ø108 x 175
BERYL SURFACE LED COMPACT 2800 13°-60°	3108	18,4	4000	Ø108 x 175
BERYL SURFACE LED COMPACT 2800	3108	18,4	4000	Ø108 x 175
BERYL SURFACE LED COMPACT 3600 13°-60°	4111	26,4	4000	Ø108 x 175
BERYL SURFACE LED COMPACT 3600	4111	26,4	4000	Ø108 x 175

## Technical drawing:

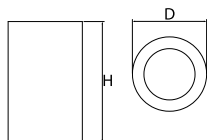

### Light and electrical features:

<b>Light source</b>	LED
<b>Voltage</b>	220..240 V, 50..60 Hz
<b>Lifetime of LED sources [h]</b>	88000 (1) / 100000 (2) / 100000 (3)/83000 (1) / 100000 (2) / 100000 (3)/91000 (1) / 100000 (2) / 100000 (3)/86000 (1) / 100000 (2) / 100000 (3)
<b>Lx/By</b>	L90/B10 (1) / L80/B10 (2) / L70/B10 (3)
<b>CRI</b>	85
<b>SDCM (LED sources)</b>	3
<b>Operating temperature range [°C]</b>	5 ÷ 30
<b>Driver</b>	standard on/off (E) DIM DALI (EDD) *
<b>Power factor cos φ</b>	>0,95

\* Variant to specify when ordering

### Mechanical features:

<b>Assembly</b>	surface mounted on ceiling
<b>Material</b>	aluminum
<b>Color</b>	RAL 9016 (white)
<b>Diffuser</b>	SH (transparent hardened glass) Micro-PRM (micro-prismatic diffuser PMMA) PLX (PMMA opal) SHM (hardened mat glass)

### Additional information:

The luminaire can be made in CLO version.

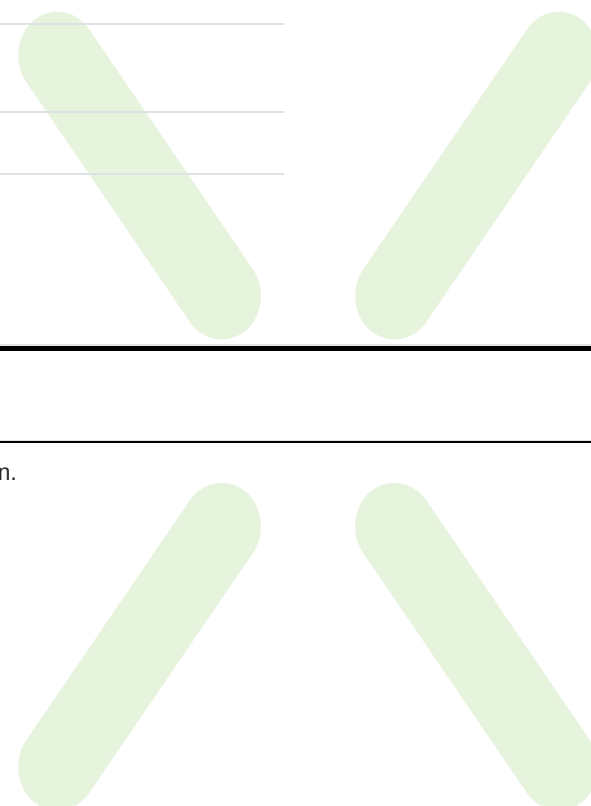

Note: The power shown refers to the whole system (tolerance +/- 10%).  
The given luminous flux refers to LED light sources (tolerance +/- 10% depends on the value of the colour temperature).  
Technical data may be changed. Photos of the luminaires may differ from reality.  
Date of last update: 13-04-2026