



AGALINE LED 3R

Industrial luminaires



Agaline 3R is a single linear luminaire designed for mounting on slings. The body is made of white powder-coated steel sheet. Optical system based on lenses providing different light distribution. High level of protection against penetration of dust and water - IP65. Agaline is an excellent solution for lighting industrial facilities and warehouses, but also finds application in offices, supermarkets and shops.





Main parameters:

Name	Luminous flux LED [lm]	Power of luminaire [W]	Color [K]	Dimensions A x B x H [mm]
AGALINE LED 3R 10800	11442 / 12006	72,6	3000 / 4000 / 5000	940 x 95 x 68
AGALINE LED 3R 14400	15256 / 16008	96,8	3000 / 4000 / 5000	1250 x 95 x 68
AGALINE LED 3R 18000	19070 / 20010	121	3000 / 4000 / 5000	1550 x 95 x 68
AGALINE LED 3R 21600	22884 / 24012	145,2	3000 / 4000 / 5000	1860 x 95 x 68

Technical drawing:

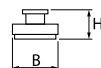
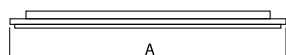

Light and electrical features:

Light source	LED
Voltage	220..240 V, 50..60 Hz
Lifetime of LED sources [h]	90000
Lx/By	L80B10
CRI	>80
SDCM (LED sources)	3
Photobiological risk class (IEC/EN 62471)	RG0
Operating temperature range [°C]	-25 ÷ 35
Driver	standard on/off (E) DIM DALI (EDD) *
Power factor cos φ	>0,95

* Variant to specify when ordering

Mechanical features:

Assembly	surface mounted on slings
Material	steel sheet
Color	RAL 9016 (white)
Diffuser	OPTICS (optical system based on lenses)

Note: The power shown refers to the whole system (tolerance +/- 10%).
The given luminous flux refers to LED light sources (tolerance +/- 10% depends on the value of the colour temperature).
Technical data may be changed. Photos of the luminaires may differ from reality.
Date of last update: 13-12-2024