

Product: X-LINE SLIM SURFACE LED 2200 PLX EDD 24 840 LINE-1EL / L-574MM

Index: 19.3112.0010.24



Description

Luminaire for building long light lines made of aluminum profile. Comparing to the traditional X-Line LED, size of the luminaire has been reduced, and all construction has been closed in a narrow 48 mm profile, which gives now a more elegant form of the product. The X-Line Slim uses a PLX or Micro-PRM opal diffuser. All of this allows to manipulate light and create lighting systems, facilitating the creation of comfortable vision in the interiors and their aesthetic appearance. The X-Line Slim luminaire is designed for mounting on ceiling. Power supply connection only via EL-marked luminaire.

Product information

Category	Surface mounted luminaires
Family	X-LINE SLIM SURFACE LED LINE
Name	X-LINE SLIM SURFACE LED 2200 PLX EDD 24 840 LINE-1EL / L-574MM
Index	19.3112.0010.24



Light and electrical data

Light source	LED
Luminous flux LED [lm]	2283
LED power [W]	11,7
Luminaire luminous flux [lm]	1465
Power of luminaire [W]	12,6
Luminaire's light efficiency [lm/W]	116,3
Color of the light [K]	4000
CRI	>80
SDCM (LED sources)	3
Beam angle [°]	(C0-C180) / (C90-C270) - 96,4° / 90,2°
Protection against electric shock	I
Protection degree	IP40
Voltage	220..240 V, 50..60 Hz
Lifetime of LED sources [h]	100000 (1) / 147000 (2)
Lx/By	L80/B10 (1) / L70/B10 (2)
Operating temperature range [°C]	5 ÷ 30
Driver	DIM DALI (EDD)
Power factor cos φ	>0,95
Circuit load capacity	14 (B10), 24 (B16), 22 (C10), 36 (C16)

Mechanical data

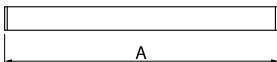

Assembly	surface mounted on ceiling
Material	aluminum
Color	anodised aluminum
Diffuser	PLX (PMMA opal)
Impact resistant	IK04
Dimensions [mm]	574 x 48 x 70

A graph of light

