



X-LINE SLIM SURFACE LED

Surface mounted luminaires



The luminaire is made of aluminum profile. Comparing to the traditional X-Line LED, size of the luminaire has been reduced, and all construction has been closed in a narrow 48 mm profile, which gives now a more elegant form of the product. The X-Line Slim uses a PLX or Micro-PRM opal diffuser. All of this allows to manipulate light and create lighting systems, facilitating the creation of comfortable vision in the interiors and their aesthetic appearance. The X-Line Slim luminaire is designed for mounting on ceiling.



"Haven House" residential, Warsaw



Main parameters:

Name	Luminous flux LED [lm]	Power of luminaire [W]	Color [K]	Dimensions A x B x H [mm]
X-LINE SLIM SURFACE LED 2600	2617	14,4	4000	1138 x 48 x 70
X-LINE SLIM SURFACE LED 3900	3926	21,7	4000	1698 x 48 x 70
X-LINE SLIM SURFACE LED 4400	4565 / 4406 / 4304÷4574 (2700÷6500 K)	24,7 / 32	4000 / 2700 ÷ 6500 / 3000	1138 x 48 x 70 / 1144 x 48 x 70
X-LINE SLIM SURFACE LED 4400 TUNABLE WHITE	4304÷4574 (2700÷6500 K)	32	2700 ÷ 6500	1144 x 48 x 70
X-LINE SLIM SURFACE LED 5200	5234	28,2	4000	2258 x 48 x 70
X-LINE SLIM SURFACE LED 5500	5526 / 5727 / 5380÷5717 (2700÷6500 K)	30,5 / 40	4000 / 2700 ÷ 6500 / 3000	1425 x 48 x 70
X-LINE SLIM SURFACE LED 5500 TUNABLE WHITE	5380÷5717 (2700÷6500 K)	39	2700 ÷ 6500	1425 x 48 x 70
X-LINE SLIM SURFACE LED 6600	6848	35,3	4000	1700 x 48 x 70
X-LINE SLIM SURFACE LED 8800	9130	49,1	4000	2258 x 48 x 70

Technical drawing:

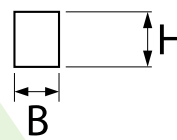
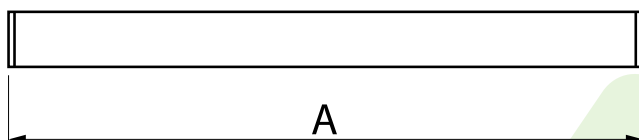

Light and electrical features:

Light source	LED
Voltage	220..240 V, 50..60 Hz
Lifetime of LED sources [h]	100000 (1) / 147000 (2)/50000
Lx/By	L80/B10 (1) / L70/B10 (2)/L80/B10
CRI	>80
SDCM (LED sources)	3
Operating temperature range [°C]	5 ÷ 30
Driver	standard on/off (E) DIM DALI (EDD) *
Power factor cos φ	>0,95

* Variant to specify when ordering

Mechanical features:

Assembly	surface mounted on ceiling
Material	aluminum
Color	anodised aluminum
Diffuser	Micro-PRM (micro-prismatic diffuser PMMA) PLX (PMMA opal) OPTICS (optical system based on lenses)

Additional information:

The luminaire can be made in CLO version.

Note: The power shown refers to the whole system (tolerance +/- 10%).
The given luminous flux refers to LED light sources (tolerance +/- 10% depends on the value of the colour temperature).
Technical data may be changed. Photos of the luminaires may differ from reality.
Date of last update: 23-12-2022