



## BERYL SURFACE NEW LED K/L2 UGR<19

UGR<19 luminaires



Downlight surface mounted luminaire made of cast aluminum. Luminaire is dedicated for prestigious interiors such as hotels, banks and offices of higher standard. Owing to the newest components and renowned producers of LEDs applied it was possible to build such luminaires which save energy consumption comparing with traditional solutions. The luminaire has the ability to adjust the optics in two planes (in the vertical axis by 359° and to the left and right 15°). Note: the color of the frame and housing has a slightly different shade than the color of the inner reflector cover.





## Main parameters:

| Name                              | Luminous flux LED [lm] | Power of luminaire [W] | Color [K] | Dimensions A x B x H [mm] |
|-----------------------------------|------------------------|------------------------|-----------|---------------------------|
| BERYL SURFACE NEW LED K-1/L2 1800 | 4116                   | 25,6                   | 4000      | 251 x 130 x 152           |
| BERYL SURFACE NEW LED K-2/L2 3600 | 8610                   | 51                     | 4000      | 341 x 167 x 180           |

## Technical drawing:

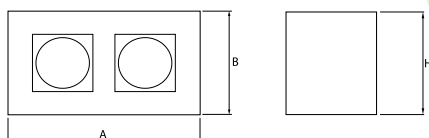

## Light and electrical features:

|                                  |   |
|----------------------------------|---|
| Light source                     | LED   |
| Voltage                          | 220..240 V, 50..60 Hz   |
| Lifetime of LED sources [h]      | 83000 (1) / 100000 (2) / 100000 (3)/86000 (1) / 100000 (2) / 100000 (3) |
| Lx/By                            | L90/B10 (1) / L80/B10 (2) / L70/B10 (3)                                 |
| CRI                              | 85/80   |
| SDCM (LED sources)               | 2   |
| Operating temperature range [°C] | 5 ÷ 30  |
| Driver                           | standard on/off (E)   |
| Power factor cos φ               | >0,95   |

## Mechanical features:

|          |                                       |
|----------|---------------------------------------|
| Assembly | surface mounted on ceiling            |
| Material | aluminum                              |
| Color    | RAL 9005 (black)                      |
| Diffuser | transparent PMMA<br>transparent glass |

Note: The power shown refers to the whole system (tolerance +/- 10%).  
The given luminous flux refers to LED light sources (tolerance +/- 10% depends on the value of the colour temperature).  
Technical data may be changed. Photos of the luminaires may differ from reality.  
Date of last update: 23-12-2022