



BERYL SURFACE LED COMPACT

Compact



Small downlight ceiling luminaire. Several variants of the diffusers and different light distributions available. Simple assembly. Perfect for lighting corridors, reception, cloakrooms.



Main parameters:

Name	Luminous flux LED [lm]	Power of luminaire [W]	Color [K]	Dimensions D x H [mm]
BERYL SURFACE LED COMPACT 1000 13°	1328	10	4000	Ø108 x 175
BERYL SURFACE LED COMPACT 1000 24°	1328	10	4000	Ø108 x 175
BERYL SURFACE LED COMPACT 1000 36°	1328	10	4000	Ø108 x 175
BERYL SURFACE LED COMPACT 1000 60°	1328	10	4000	Ø108 x 175
BERYL SURFACE LED COMPACT 1000	1328	10	4000	Ø108 x 175
BERYL SURFACE LED COMPACT 1800 13°	2058	13	4000	Ø108 x 175
BERYL SURFACE LED COMPACT 1800 24°	2058	13	4000	Ø108 x 175
BERYL SURFACE LED COMPACT 1800 36°	2058	13	4000	Ø108 x 175
BERYL SURFACE LED COMPACT 1800 60°	2058	13	4000	Ø108 x 175
BERYL SURFACE LED COMPACT 1800	2058	13	4000	Ø108 x 175
BERYL SURFACE LED COMPACT 2800 13°-60°	3108	18	4000	Ø108 x 175
BERYL SURFACE LED COMPACT 2800	3108	18	4000	Ø108 x 175
BERYL SURFACE LED COMPACT 3600 13°-60°	4111	26	4000	Ø108 x 175
BERYL SURFACE LED COMPACT 3600	4111	26	4000	Ø108 x 175

Technical drawing:

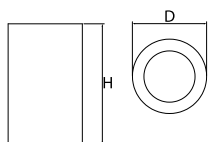

Light and electrical features:

Light source	LED
Voltage	220..240 V, 50..60 Hz
Lifetime of LED sources [h]	88000 (1) / 100000 (2) / 100000 (3)/83000 (1) / 100000 (2) / 100000 (3)/91000 (1) / 100000 (2) / 100000 (3)/86000 (1) / 100000 (2) / 100000 (3)
Lx/By	L90/B10 (1) / L80/B10 (2) / L70/B10 (3)
CRI	85
SDCM (LED sources)	3
Operating temperature range [°C]	5 ÷ 30
Driver	standard on/off (E) DIM DALI (EDD) *
Power factor cos φ	>0,95

* Variant to specify when ordering

Mechanical features:

Assembly	surface mounted on ceiling
Material	aluminum
Color	RAL 9016 (white)
Diffuser	none Micro-PRM (micro-prismatic diffuser PMMA) PLX (PMMA opal) SHM (hardened mat glass)

Additional information:

The luminaire can be made in CLO version.

Note: The power shown refers to the whole system (tolerance +/- 10%).
The given luminous flux refers to LED light sources (tolerance +/- 10% depends on the value of the colour temperature).
Technical data may be changed. Photos of the luminaires may differ from reality.
Date of last update: 23-12-2022