

Product: STREETPARK M LED 14100 STREET-M1 EDD IP66 22 740 / SP/V / ENEC

Index: 19.3259.0025.22



Description

Body made of cast aluminium painted with weather resistant powder paint. Two-chamber construction, tool-less access to the electrical and optical chamber without removing the luminaire from the pole. Flat construction, without any protruding elements or ribs, with a self-cleaning construction (minimum angle of inclination of the radiator surface to allow self-cleaning during rainfall). Cable gland for power cable with cross-section from 9.5 mm to fi 12 mm. Two brackets available: 48 mm and 60 mm. Tilt angle adjustment from -20° to +20° and from -5° to +20° (for 90° extension arm mounting). THD harmonic content < 8%. The luminaire has additional overvoltage protection (protecting both the luminaire elements and the driver), which is 10 kV / 5 kA. Optionally the luminaire is equipped with a Nema Socket 7 pin or Zhaga type socket. Product with ENEC and ENEC PLUS certificate.

Product information

Category	Outdoor luminaires
Family	STREETPARK M LED ENEC
Name	STREETPARK M LED 14100 STREET-M1 EDD IP66 22 740 / SP/V / ENEC
Index	19.3259.0025.22



Light and electrical data

Light source	LED
Luminous flux LED [lm]	14720
LED power [W]	79
Luminaire luminous flux [lm]	12865
Power of luminaire [W]	87
Luminaire's light efficiency [lm/W]	148
Color of the light [K]	4000
CRI	>70
Beam angle [°]	street light distribution
Photobiological risk class (IEC/EN 62471)	RG0
Protection against electric shock	II
Protection degree	IP66
Voltage	220..240 V, 50..60 Hz
Lifetime of LED sources [h]	100000
Lx/By	L90/B10
Operating temperature range [°C]	-40 ÷ 50
Driver	DIM DALI (EDD)

Mechanical data

Assembly	mounted on poles
Material	aluminum
Color	RAL 9007 (dark gray)
Diffuser	hardened transparent glass with a thickness of 5 mm
Impact resistant	IK10
Dimensions [mm]	718 x 311 x 103

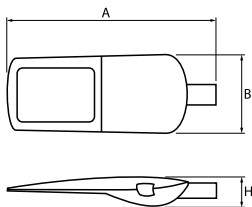

A graph of light

